

# MEDINA COURTHOUSE STEERING COMMITTEE



DESIGN  
UPDATE

September 14,  
2020



# WHAT WE KNOW



OLD COURTHOUSE (99 PUBLIC SQUARE)



CURRENT COUNTY COURTHOUSE (93 PUBLIC SQUARE)



STURGIS HOUSE (72 PUBLIC SQUARE)

- THREE EXISTING BUILDINGS ON THE EAST SIDE OF THE SQUARE ARE TO REMAIN
- NEW COURTHOUSE TO BE CONSTRUCTED BEHIND IN THE EXISTING PARKING LOT.
- NEW COURTHOUSE WILL INCLUDE:
  - MUNICIPAL CLERK AND MUNICIPAL COURT
  - COUNTY CLERK
  - SALLYPORT AND SECURE HOLD AREAS
  - COMMON PLEAS COURT
  - DOMESTIC RELATIONS COURT
  - JUVENILE AND PROBATE COURTS, JUVENILE PROBATION
- OLD COUNTY COURTHOUSE (99 PUBLIC SQ) WILL BE RENOVATED TO INCLUDE:
  - MUNICIPAL ADULT PROBATION
  - COUNTY ADULT PROBATION
- PLANNED FOR FUTURE GROWTH
  - 2<sup>ND</sup> MUNICIPAL COURTROOM
  - 3<sup>RD</sup> COMMON PLEAS COURTROOM
  - SEPARATE PROBATE COURTROOM
  - 2<sup>ND</sup> DOMESTIC RELATIONS COURTROOM
- 130,000 SQUARE-FEET TOTAL
- \$38 MILLION



# USER GROUP REVIEWS

08-20-2020

COMMON PLEAS COURT

08-20-2020

COUNTY CLERK

08-20-2020

MUNICIPAL COURT/PROBATION

08-21-2020

JUVENILE/PROBATE COURT

08-25-2020

COUNTY ADULT PROBATION

08-25-2020

SHERIFF DEPARTMENT

PENDING

DOMESTIC RELATIONS COURT

# SITE PLAN

Renovate Old Courthouse

Maintain 1969 Courthouse

Maintain Sturgis House

New Courthouse behind

New entry to the South

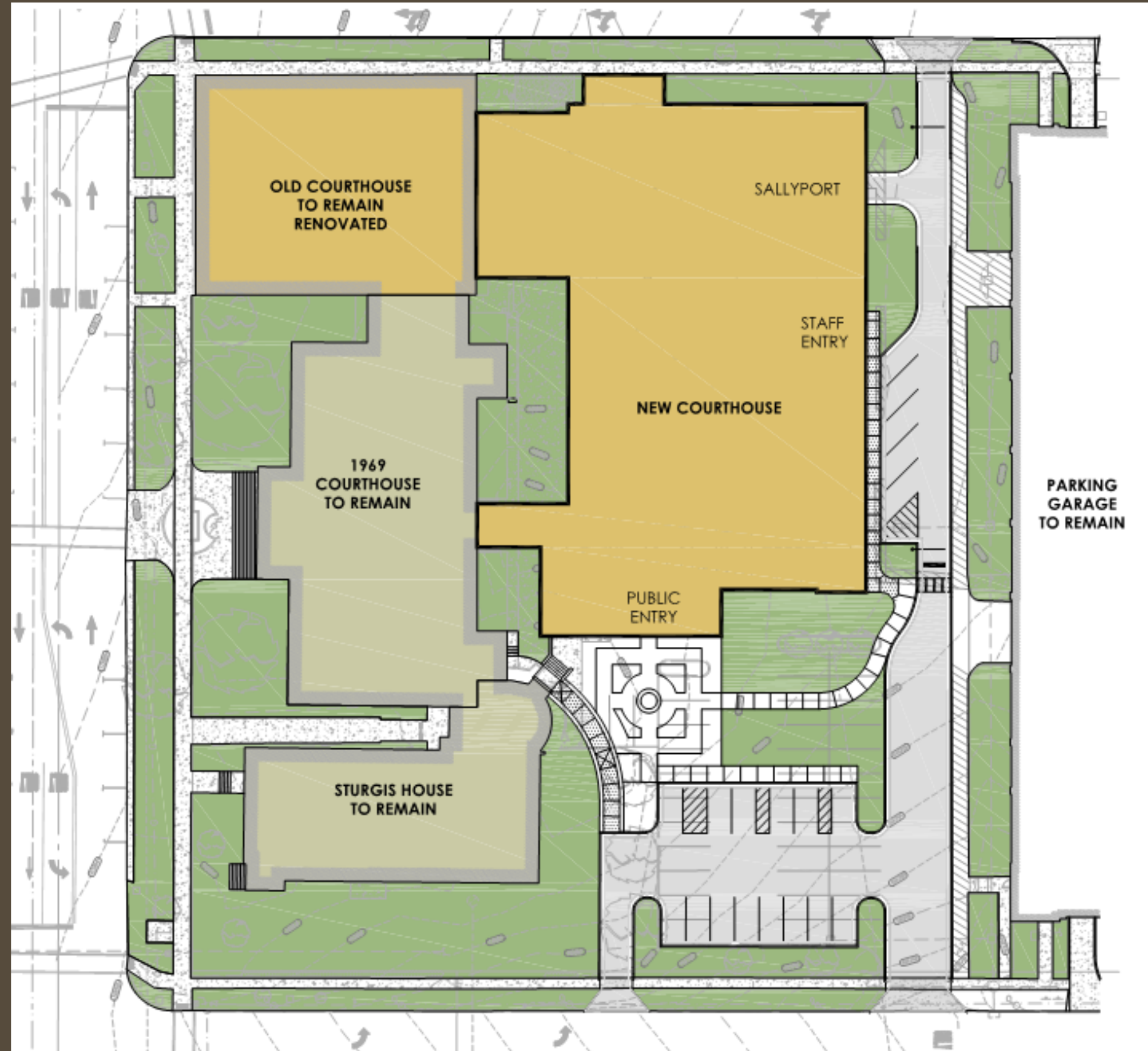

# FIRST FLOOR PLAN

MAIN PUBLIC ENTRY  
COUNTY CLERK RECORDS  
SALLYPORT/HOLD  
MUNICIPAL RECORDS  
BUILDING SUPPORT



# SECOND FLOOR PLAN

COUNTY CLERK  
MUNICIPAL COURT  
MUNICIPAL CLERK  
MUNICIPAL PROBATION



# THIRD FLOOR PLAN

COMMON PLEAS COURT  
COUNTY ADULT PROBATION



# FOURTH FLOOR PLAN

DOMESTIC RELATIONS  
COURT

FUTURE COMMON PLEAS  
COURT

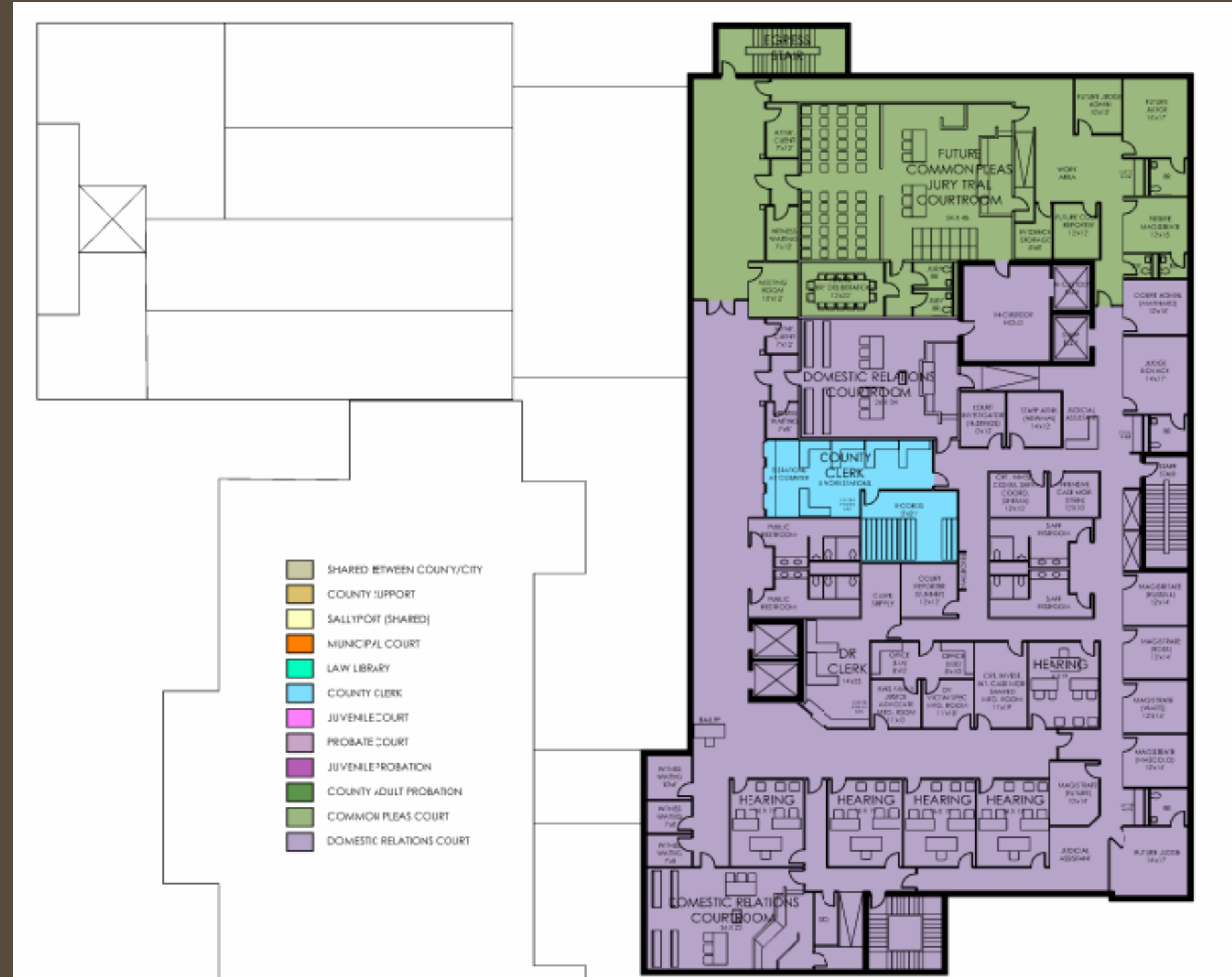



# FIFTH FLOOR PLAN

PROBATE COURT  
JUVENILE COURT  
JUVENILE PROBATION

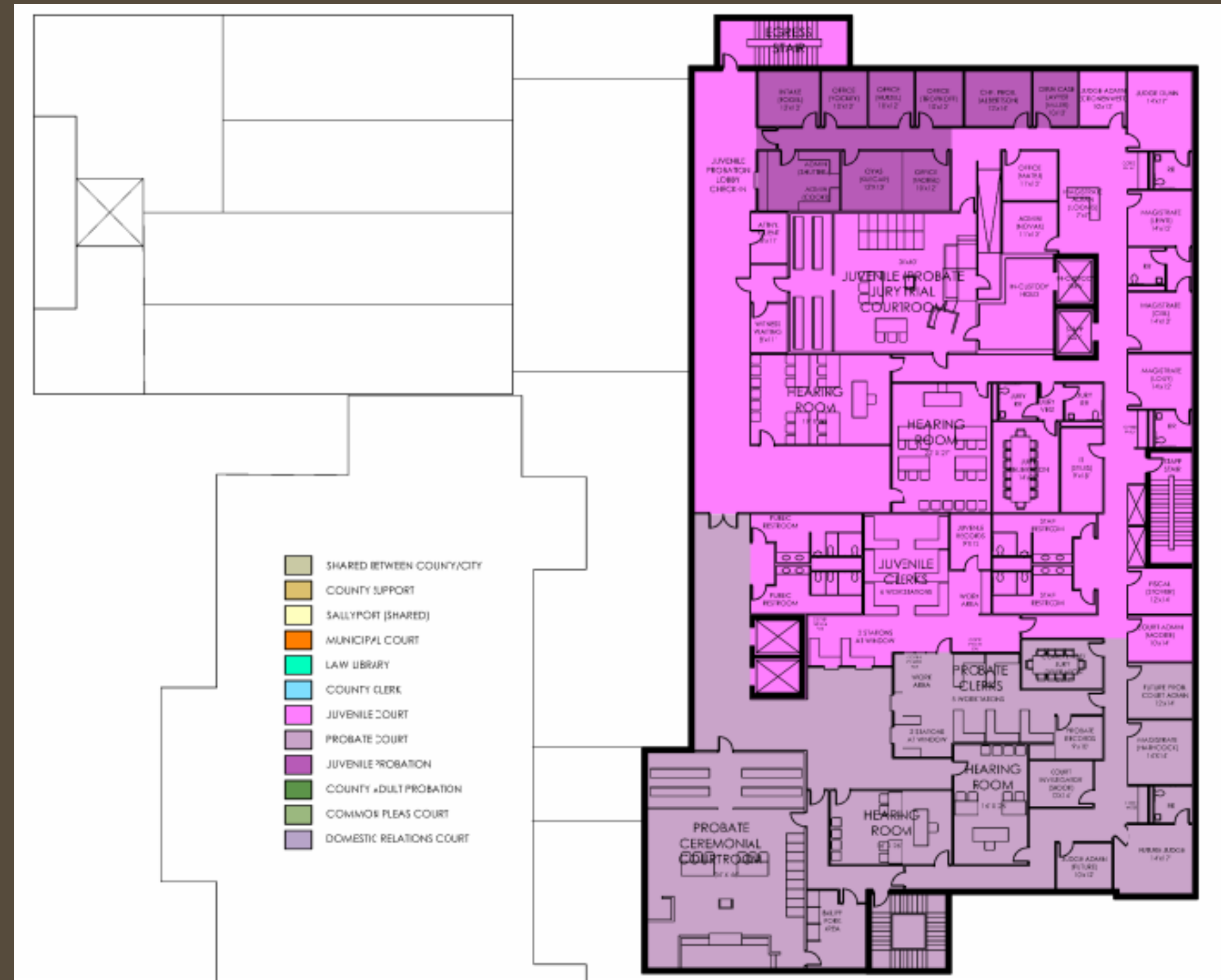

# CURRENT PLAN



OLD COURTHOUSE (99 PUBLIC SQUARE)



CURRENT COUNTY COURTHOUSE (93 PUBLIC SQUARE)



STURGIS HOUSE (72 PUBLIC SQUARE)

14,900 SQUARE FEET RENOVATION

\$38 MILLION CONSTRUCTION COST

114,400 SQUARE FEET NEW CONSTRUCTION

21% MUNICIPAL COURT: \$8 MILLION

129,300 SQUARE FEET TOTAL PROJECT

79% COUNTY COURT: \$30 MILLION