

Handouts at
March 6, 2020
Medina County
Bar Association
Meeting from
Commissioner
Pat Geissman

SITE PLAN

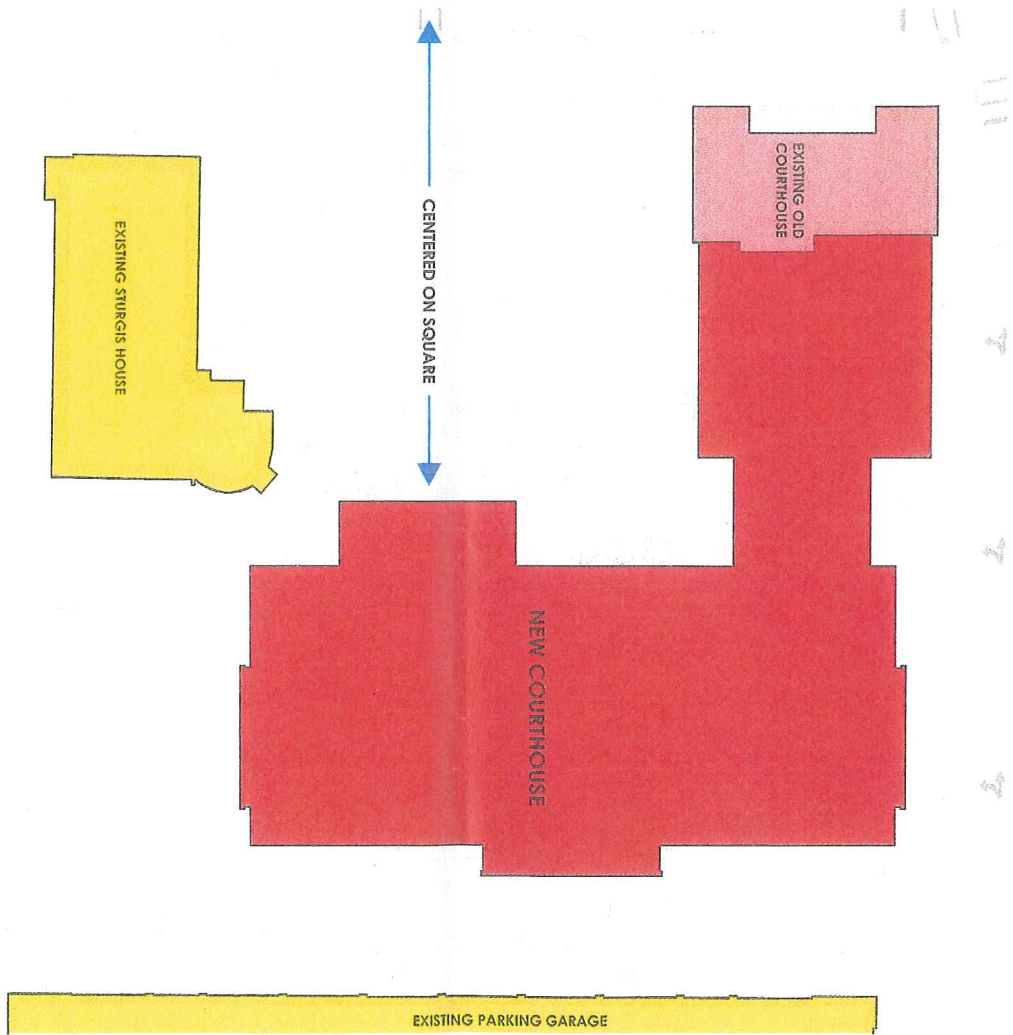

02/25/2020



MEDINA COURTHOUSE
MEDINA, OHIO

County/Municipal Courts

Needs:

County Court	67,000 SF
Municipal Court	24,000 SF
<u>Shared Space</u>	<u>38,000 SF</u>
Total:	129,000 SF

All figures are estimates

Option 1 – New courthouse on the square

Tear down everything except 1841 building. Approximately 60-80' back. \$43.7 M

**Employees must re-locate for approximately 2 years to temporary court location. \$2 M to renovate temporary court and \$370,000 a year to lease building. 3 locations have been considered – Litchfield Elementary School is best suited.

Option 2 – Keep 1840 building and only façade of 1969 building.

\$44.6 M **

Option 3 – Maintain existing buildings with an addition.

85,000 additional SF. Minor renovation. \$41 M **

Option 4 – Maintain existing building exterior walls with an addition.

Major renovation. \$45.5M **

Option 5 – New courthouse on square with forecourt.

Maintain 1969 courthouse during construction only. \$38.1M

Option 6 – Build new courthouse off square out by jail.

No need to move employees. \$39.3 M. Need to buy land and possibly pay city for the parking deck.